

Notes:

Electrical characteristics

- 1. Impedance: 50Ω
- 2. Working voltage: $\leq 250V$
- 3. Insulation resistance: $\geq 1000M \Omega$
- 4. Dielectric strength: $750V$
- 5. Contact resistance

Center contact $\leq 6m \Omega$
 Outer contact $\leq 1m \Omega$

Material&Finish

Inner Contact: Beryllium copper, gold plated
 Outer Contact: Brass, gold plated
 Insulators: Teflon

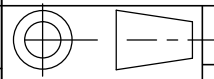

Scale

1:1

Name Date

Designed Tomson 19-Aug-11

Checked Jason 19-Aug-11

Approved Teresa 19-Aug-11

SMB-KW3
 RF Coaxial Connector

UNLESS OTHERWISE SPECIFIED
 DIMENSIONS ARE mm, TOLERANCES ARE:
 FRACTIONS DECIMALS ANGLES
 .X± .15 ±1°
 .XX± .05
 .XXX±

Danyang Teruilai Electronics Co., Ltd.