

This document contains proprietary information and such information may not be disclosed to others for any purposes,  
not used for sales/marketing/procurement purposes without written permission

REV	DESCRIPTION OF REVISION	ECN NO.	BY	DATE	APPROVED
A	Initial Release	—	T.Shihua	18/02/14	18/02/14

## 1 Electrical

1.1 Impedance: 50Ω

1.2 Frequency: DC-300MHz

## 2 Mechanical

2.1 Center contact: solder

## 3 Environmental

3.1 RoHs compliant

3.2 Operating temperature -65° to 165°

## 4 Material&Finish

4.1 Inner Contact: phosphor bronze, gold plated

4.2 Outer Contact: nickel, gold plated

4.3 Insulators: PTFE

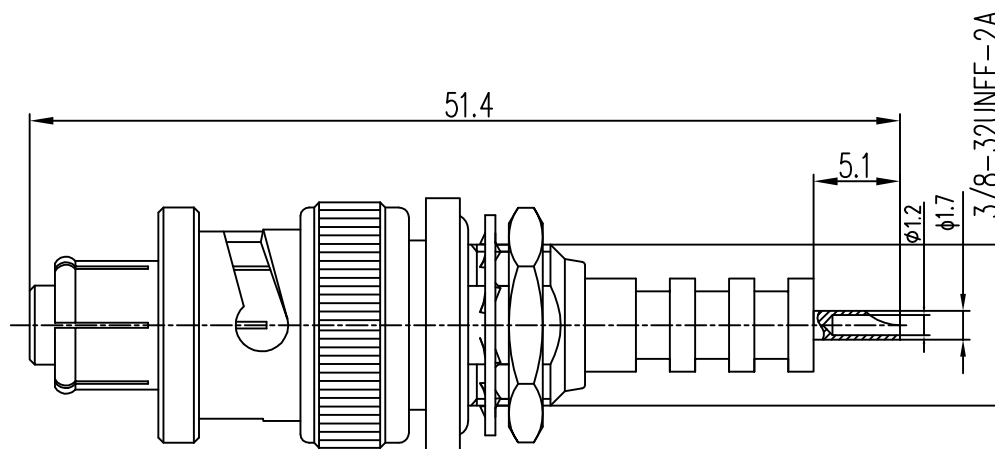

### Notes:

- 1.ALL SPECIFICATIONS ARE SUBJECT TO CHANGE NOTICE AT ANY TIME
- 2.CUSTOMER OUTLINE DRAWING FOR REFERENCE ONLY

DRAWN: T.Shihua 18/02/14  
ENGINEER: C.Tao 18/02/14  
APPROVED: W.Qiang 18/02/14

TOLERANCES UNLESS OTHERWISE SPECIFIED  
.X ±0.50  
.XX ±0.20  
.XX ±0.10  
ANGLES ±1°

TITLE:  
SHV-KYD1  
SHV Female Bulkhead Connector  
For Terminal

PART NO: TRL-SHV-26386



www.t-rely.com.cn



DIMENSION IN MILLIMETERS (mm)

SIZE:  
A4

SCALE:  
N/A

SHEET:  
1/1

REV:  
A