

This document contains proprietary information and such information may not be disclosed to others for any purposes, not used for sales/marketing/procurement purposes without written permission

- 1 Electrical data
 - 1.1 Impedance: 50 Ω
 - 1.2 Frequency: DC-6GHz
 - 1.3 VSWR 1:30:1
- 2 Mechanical data
 - 2.1 Temperature range -45°C ~+125°C
 - 2.2 Durability(matings) >500
- 3 Material&Finish
 - 3.1 Contact: Brass, gold plated
 - 3.2 Body:Brass, nickel plated
 - 3.3 Insulators: PTFE

(37.7)

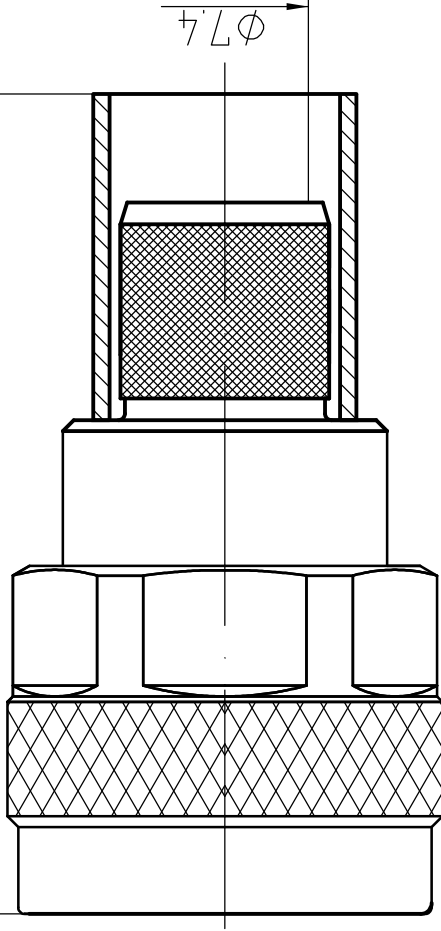

Notes:

- 1. ALL SPECIFICATIONS ARE SUBJECT TO CHANGE NOTICE AT ANY TIME
- 2. CUSTOMER OUTLINE DRAWING FOR REFERENCE ONLY

| REV | DESCRIPTION OF REVISION | ECN NO. | BY | DATE | APPROVED |
|-----|-------------------------|---------|-----------|----------|----------|
| A | Initial Release | | T. Shihua | 18/02/14 | 18/02/14 |

| | | |
|---------------------------------------|---------------------------|------------|
| DRAWN: T. Shihua 18/02/14 | TITLE: | |
| ENGINEER: C. Tao 18/02/14 | RF Coaxial Connector | |
| APPROVED: W. Qiang 18/02/14 | N Male Straight Connector | |
| TOLERANCES UNLESS OTHERWISE SPECIFIED | For LMR400 Cable | |
| X +0.50 | SCALE: N/A | SHEET: 1/1 |
| .X +0.20 | SIZE: A4 | REV: A |
| .XX +0.10 | | |
| ANGLES ±° | | |

| | | | |
|--|--|-------------------------------|--|
| | | www.teruihai.com | |
| | | DIMENSION IN MILLIMETERS (mm) | |