

This document contains proprietary information and such information may not be disclosed to others for any purposes, not used for sales/marketing/procurement purposes without written permission

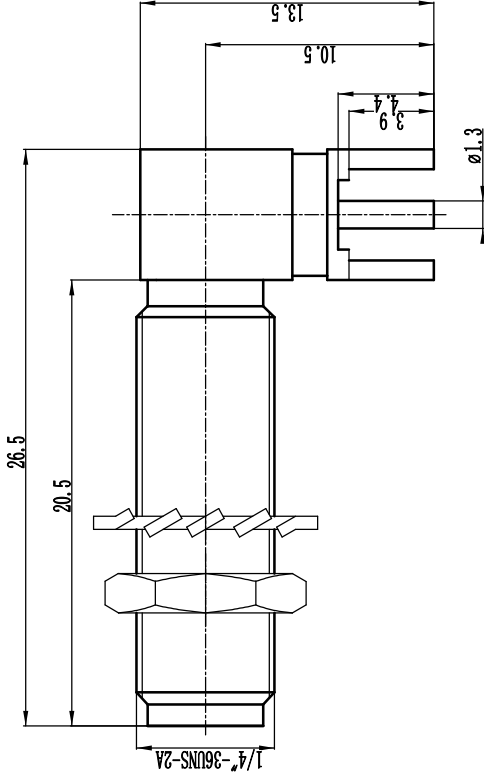

Recommended Mounting Hole

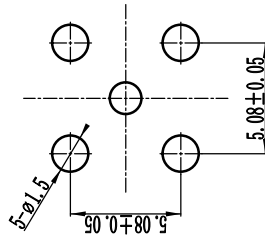

- 1. Electrical
 - 1.1 Impedance: 50 Ω
 - 1.2 Frequency: DC~6GHz
 - 1.2 Dielectric withstanding voltage: 1000V (volts RMS)
 - 1.3 Center contact resistance: ≤ 2mΩ
 - 1.4 Outer contact resistance: ≤ 3mΩ
 - 1.5 Insulation resistance: ≥5000MΩ
 - 1.6 VSWR: 1.30: 1
- 2. Environmental&Mechanical
 - 2.1 Temperature range: -45℃~125℃
 - 2.2 RoHS Compliant
 - 2.3 Durability: >500 cycles
- 3. Materials&plating
 - 3.1 Body: Brass, Gold plated
 - 3.2 Insulator: Teflon
 - 3.3 Contact Pin: Bronze Gold plated

REV	DESCRIPTION OF REVISION	ECN NO.	BY	DATE	APPROVED
A	Initial Release		T. Haiyun	12/7/08	12/7/08

DRAWN: T. Haiyun 12/07/08		TITLE: RF Coaxial Connector	
ENGINEER: C. Tao 12/07/08		SMA Female B/H Right Angle Conn. For PCB	
APPROVED: W. Qiang 12/07/08		PART NO: SMA-KYWH22	
TOLERANCES UNLESS OTHERWISE SPECIFIED		SCALE: 1:1	
X ±0.50	.X ±0.20	SHEET: 1/1	
.XX ±0.10	ANGLES ±1°	REV: A	
www.t-comnetec-china.com		DIMENSION IN MILLIMETERS (mm)	

Notes:

- 1. ALL SPECIFICATIONS ARE SUBJECT TO CHANGE NOTICE AT ANY TIME
- 2. CUSTOMER OUTLINE DRAWING FOR REFERENCE ONLY