

This document contains proprietary information and such information may not be disclosed to others for any purposes, not used for sales/marketing/procurement purposes without written permission

- 1 Electrical
  - 1.1 Impedance: 50  $\Omega$
  - 1.2 Frequency: DC-6GHz
  - 1.3 VSWR: 1.20:1
- 2 Mechanical & Environmental
  - 2.1 Temperature range -45°C ~ +125°C
  - 2.2 Durability (matings) >500
  - 2.3 RoHS Compliant Yes
- 3 Material & Finish
  - 3.1 Pin contact: Beryllium-Copper, gold plated
  - 3.2 Body: Brass, gold plated
  - 3.3 Insulators: teflon

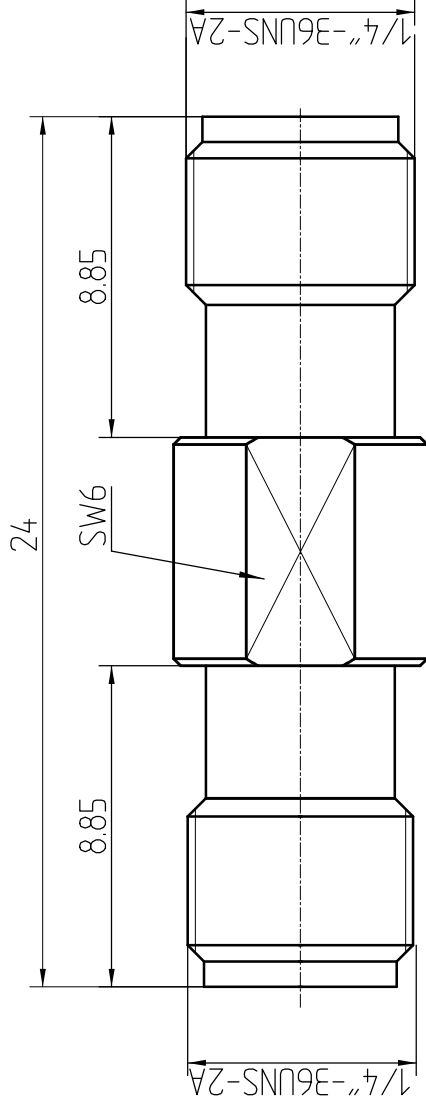

**Notes:**

- 1. ALL SPECIFICATIONS ARE SUBJECT TO CHANGE NOTICE AT ANY TIME
- 2. CUSTOMER OUTLINE DRAWING FOR REFERENCE ONLY

REV	DESCRIPTION OF REVISION	ECN NO.	BY	DATE	APPROVED
A	Initial Release		T. Shihua	1/8/14	1/8/14

DRAWN: T. Shihua 1/8/14		TITLE: RF Adapter		www.teruilai.com	
ENGINEER: C. Tao 1/8/14		SMA Female to SMA Female		DIMENSION IN MILLIMETERS (mm)	
APPROVED: W. Qiang 1/8/14		PART NO: SMA-KK-E		SCALE: N/A	
TOLERANCES UNLESS OTHERWISE SPECIFIED		SIZE: A4		SHEET: 1/1	
X	+0.50	REV: A			
.X	+0.20				
.XX	+0.10				
ANGLES	*°				