

This document contains proprietary information and such information may not be disclosed to others for any purposes, not used for sales/marketing/procurement purposes without written permission

REV	DESCRIPTION OF REVISION	ECN NO.	BY	DATE	APPROVED
A	Initial Release	—	T.Shihua	2/12/14	2/12/14

1 Electrical

- 1.1 Impedance: 50Ω
- 1.2 Frequency: 0~6GHz
- 1.3 Working voltage: ≤250V
- 1.4 Insulation resistance: ≥1000MΩ
- 1.5 Dielectric strength: 750V
- 1.6 Center Contact resistance: ≤6mΩ
- 1.7 Outer contact resistance: ≤1mΩ

2 Environmental&Mechanical

- 2.1 Temperature range: -55℃~155℃
- 2.2 RoHs Compliant
- 2.3 Durability: 500 cycles

3 Materials&plating

- 3.1 Inner Contact: Brass, gold plating
- 3.1 Outer Contact: brass, gold plated
- 3.3 Insulators: Teflon

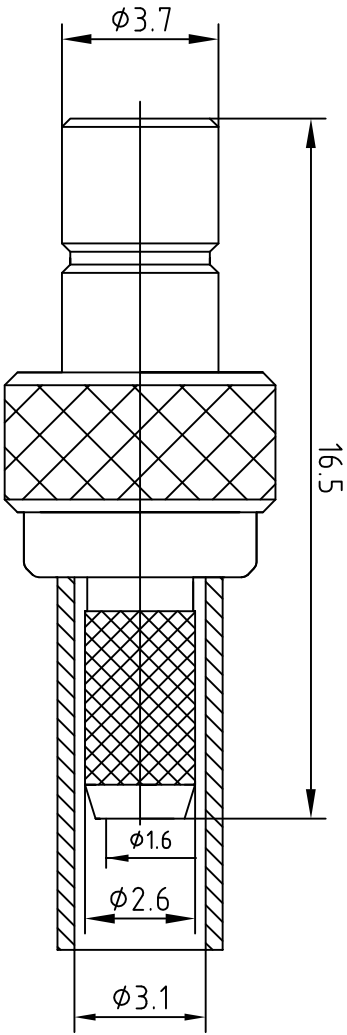

Notes:

- 1.ALL SPECIFICATIONS ARE SUBJECT TO CHANGE NOTICE AT ANY TIME
- 2.CUSTOMER OUTLINE DRAWING FOR REFERENCE ONLY

DRAWN: T.Shihua 2/12/14	TITLE: SMB-J3	SIZE: A4	SCALE: N/A	SHEET: 1/1	REV: A
ENGINEER: C.Too 2/12/14					
APPROVED: W.Qi Ding 2/12/14	SMB male conn. For RG316 Cable				
TOLERANCES UNLESS OTHERWISE SPECIFIED					
X ±0.50					
XX ±0.20					
ANGLES ±1°					
PART NO: TRL-SMBW-3410					



DIMENSION IN MILLIMETERS (mm)