

This document contains proprietary information and such information may not be disclosed to others for any purposes, not used for sales/marketing/procurement purposes without written permission

REV	DESCRIPTION OF REVISION	ECN NO.	BY	DATE	APPROVED
A	Initial Release		T.Shihua	12/7/13	12/7/13

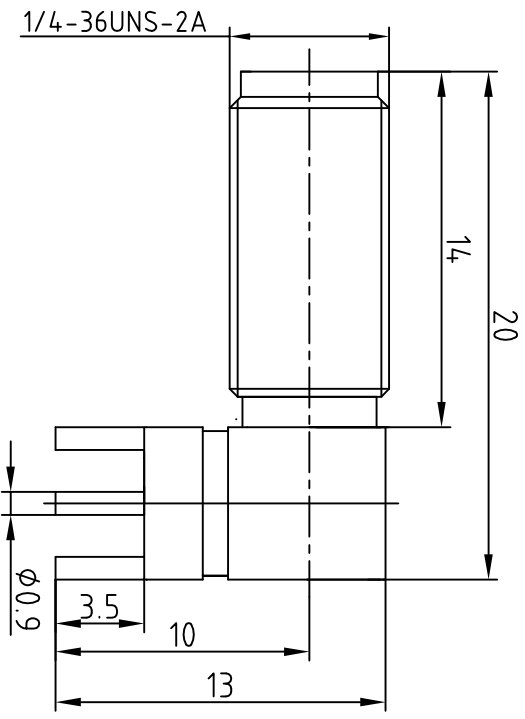

- 1 Electrical
 - 1.1 Impedance: 50Ω
 - 1.2 Dielectric withstanding voltage: 1000V(volts RMS)
 - 1.3 Center contact resistance: ≤ 3MΩ
 - 1.4 Outer contact resistance: ≤ 2MΩ
 - 1.5 Insulation resistance: ≥ 5000MΩ
- 2 Environmental&Mechanical
 - 2.1 Temperature range: -55°C~155°C
 - 2.2 RoHS Compliant
 - 2.3 Durability: >500 cycles

Mounting Hole

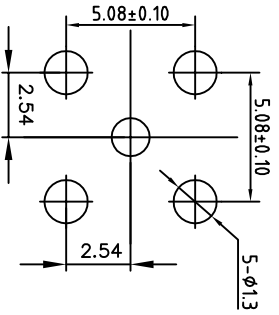

- 3 Materials&plating
 - 3.1 Body: Brass, Gold plated
 - 3.2 Insulator: Teflon
 - 3.3 Contact Pin: Brass, gold plated
 - 3.4 Washer: Brass, Gold plated
 - 3.5 Hex Nut: Brass, Gold plated

Notes:

- 1. ALL SPECIFICATIONS ARE SUBJECT TO CHANGE NOTICE AT ANY TIME
- 2. CUSTOMER OUTLINE DRAWING FOR REFERENCE ONLY

DRAWN: T.Shihua 12/07/13	TITLE: SMA-KYWH07	SMA Female bulkhead Right Angle Conn. For PCB	 www.trelytech.com
ENGINEER: C.Too 12/07/13	APPROVED: W.Qiang 12/07/13		
TOLERANCES UNLESS OTHERWISE SPECIFIED		PART NO: TRL-SMAF-5128	SIZE: A4
X ±0.30	XX ±0.20	SCALE: 1:1	SHEET: 1/1
ANGLES 30°		DIMENSION IN MILLIMETERS (mm)	REV: A