

This document contains proprietary information and such information may not be disclosed to others for any purposes, not used for sales/marketing/procurement purposes without written permission

- 1. Electrical
 - 1.1 Impedance 50 Ω
 - 1.2 Dielectric withstanding voltage 1000V (rms)
 - 1.3 Center contact resistance ≤ 3MΩ
 - 1.4 Outer contact resistance ≤ 2MΩ
 - 1.5 Insulation resistance: ≥ 5000MΩ
 - 1.6 Frequency 0~6GHz
- 2. Environmental & Mechanical
 - 2.1 Temperature range -45°C~+125°C
 - 2.2 RoHS Compliant
 - 2.3 Durability >500 Cycles
- 3. Materials & Soldering
 - 3.1 Body: Brass, Gold Plated
 - 3.2 Insulator: Teflon
 - 3.3 Contact Pin: Brass, Gold Plated
 - 3.4 Washer: Phosphor, Gold Plated
 - 3.5 Hex Nut: Brass, Gold Plated

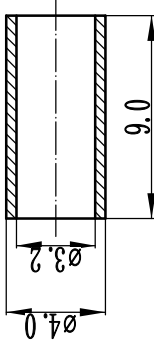
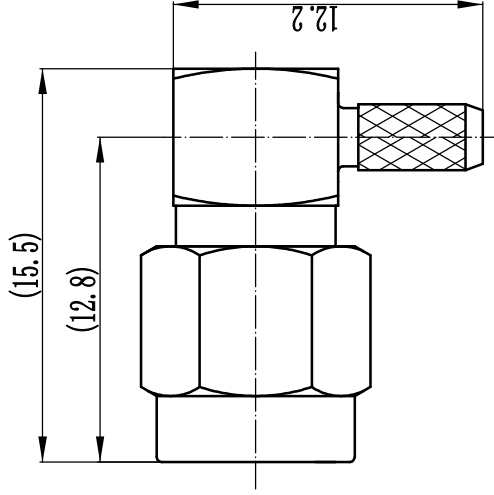

REV	DESCRIPTION OF REVISION	ECN NO.	BY	DATE	APPROVED
A	Initial Release		T. Shihua	12/7/13	12/7/13

Notes:

- 1. ALL SPECIFICATIONS ARE SUBJECT TO CHANGE NOTICE AT ANY TIME
- 2. CUSTOMER OUTLINE DRAWING FOR REFERENCE ONLY

DRAWN: T. Shihua 12/07/13
ENGINEER: C. Tao 12/07/13
APPROVED: W. Qiang 12/07/13
TOLERANCES UNLESS OTHERWISE SPECIFIED X +0.50 X +0.20 XX ±0.10 ANGLES ±°

TITLE: RF Coaxial Connector
SMA Male R/A Conn. For RG316
PART NO: SMA-JW3-N

TERULAI www.terulai.com

DIMENSION IN MILLIMETERS (mm)

SIZE: A4 SCALE: 1/A SHEET: 1/1 REV: A

A

B

A

B