

This document contains proprietary information and such information may not be disclosed to others for any purposes, nor used for sales/marketing/procurement purposes without written permission

本文件包含专有信息，没有书面许可，该信息不能以任何形式披露给第三方，也不能用于任何目的的买卖、销售及采购。

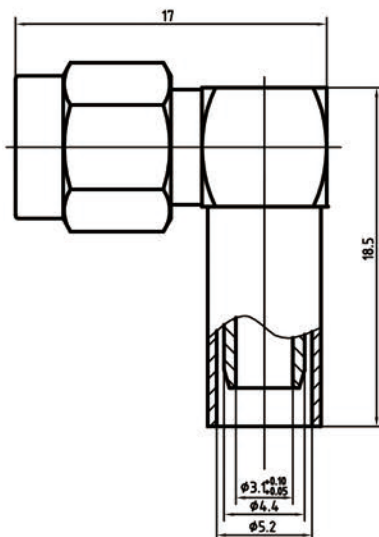

电气指标

1. 频率范围: DC~6GHz
 2. 接触电阻
内导体: $\leq 3 \text{ m}\Omega$
外导体: $\leq 2 \text{ m}\Omega$
 3. 绝缘电阻: $\geq 5000 \text{ M}\Omega$
 4. 介质耐压: 1000V(rms)
 5. 使用寿命: 500次
- 执行标准: GB681A(MIL-C-39012)

材料&镀层

1. 中心接触件: 黄铜, 镀金
 2. 外壳: 黄铜, 镀金
 3. 绝缘子: PTFE
- 适配电缆: LMR200

Electrical Characteristics:

1. Frequency range: DC~6GHz
2. Contact resistance
Center conductor: $\leq 3 \text{ m}\Omega$
Out conductor: $\leq 2 \text{ m}\Omega$
3. Insulation resistance: $\geq 5000 \text{ M}\Omega$
4. Insulator withstanding: 1000V(rms)
5. Durability: 500cycles

Application: GB681A(MIL-C-39012)

Material&Finishing

1. Center contact: **Brass, gold plated**
 2. Body :brass, gold plated
 3. Insulators: PTFE
- Cable code: LMR200

FIRST ANGLE PROJECTION		SCALE
THIRD ANGLE PROJECTION		2:1
	NAME	DATE
DRAWN	Tomson Tang	09-Aug-12
CHECKED	Magi Wang	09-Aug-12
APPROVED	Teresa Shen	09-Aug-12

SMA-JW200
RF Coaxial Connector

UNITS
mm
REV
V1.0

UNLESS OTHERWISE SPECIFIED
DIMENSIONS ARE mm, TOLERANCES ARE:
FRACTIONS DECIMALS ANGLES
.X± .20 ±1'
.XX± .10
.XXX±



www.rf-connector-china.com