

1 Electrical Data:

1. Impedance: 50Ω
2. Working voltage: $\leq 500V$
3. Insulation resistance: $\geq 5000M\Omega$
4. Dielectric withstanding voltage: $1500V$
5. Center Contact resistance $\leq 1.5M\Omega$
6. Outer Contact resistance $\leq 1.0M\Omega$

2 Material&Finish

Inner Contact: gold plated over Phosphor bronze
 Outer Contact: nickel plated over brass.
 Insulators: Teflon

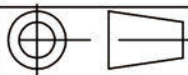

Scale

N/A

Name

Date

Designed

Tomson

24-Oct-10

Checked

Jason

24-Oct-10

Approved

Teresa

24-Oct-10

BNC-K3Y

BNC Female Conn. for RG316 cable

UNLESS OTHERWISE SPECIFIED
 DIMENSIONS ARE mm, TOLERANCES ARE:
 FRACTIONS DECIMALS ANGLES
 .X± .15 ±1°
 .XX± .05
 .XXX±



www.rf-connector-china.com