

Electrical

1. Impedance: 50Ω
2. Frequency: 0~3GHz
2. Working voltage: $\leq 250V$
3. Insulation resistance: $\geq 1000M\Omega$
4. Dielectric strength: 500V
5. Center contact resistance $\leq 5m\Omega$
6. Center contact resistance $\leq 2.5m\Omega$

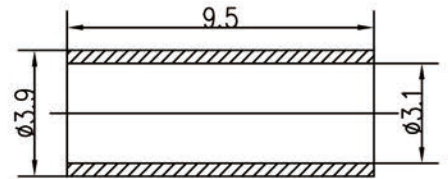

Material&Finish

1. Inner Contact: gold plated over Brass
2. Outer Contact: gold plated over brass.
3. Insulators: Teflon
4. Crimp Ferrule: brass, gold plated

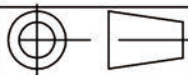

Scale

1:1

Name

Date

Designed

Tomson

4-Dec-15

Checked

Jason

4-Dec-15

Approved

Teresa

4-Dec-15

SSMB-KW3
SSMB Female RA Connector
for RG316 Cable

UNLESS OTHERWISE SPECIFIED
DIMENSIONS ARE mm, TOLERANCES ARE:
FRACTIONS DECIMALS ANGLES
.X \pm .15 $\pm 1^\circ$
.XX \pm .05
.XXX \pm



www.rf-connector-china.com