

TRL120508F

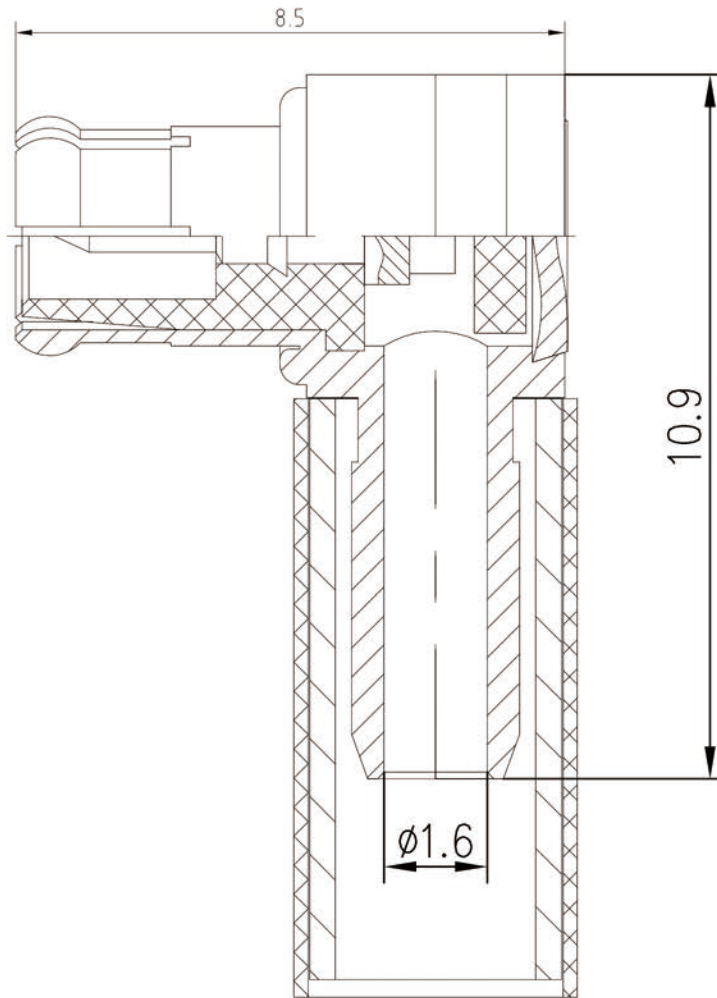

Notes:

Electrical characteristics

1. Impedance: 50Ω
2. Working voltage: $\leq 500V$
3. Insulation resistance: $\geq 1000M\Omega$
4. Dielectric withstanding voltage: $750V$
5. Contact resistance
 - Center contact $\leq 5M\Omega$
 - Outer contact $\leq 2.5M\Omega$

Material&Finish

- Inner Contact: Brass, gold plated
- Outer Contact: brass, gold plated
- Insulators: Teflon

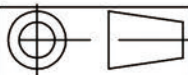

Scale

1:1

Name

Date

Designed

Tomson

24-Oct-10

Checked

Jason

24-Oct-10

Approved

Teresa

24-Oct-10

MCX-JW3

MCX male right angle

Connector for RG316 cable

UNLESS OTHERWISE SPECIFIED
DIMENSIONS ARE mm, TOLERANCES ARE:
FRACTIONS DECIMALS ANGLES
.X± .15 ±1°
.XX± .05
.XXX±



www.rf-connector-china.com