

TRL110819D

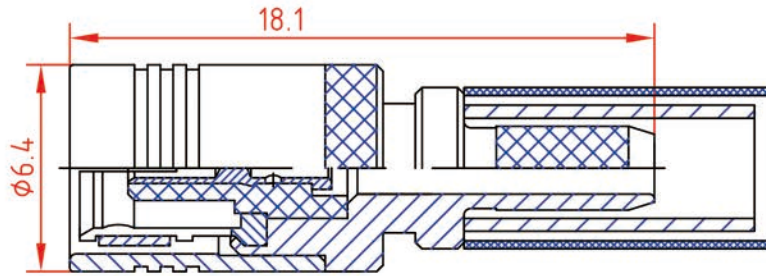

Notes:

Electrical characteristics

- 1. Impedance:  $50\Omega$
- 2. Working voltage:  $\leq 250V$
- 3. Insulation resistance:  $\geq 1000M\Omega$
- 4. Dielectric strength:  $750V$
- 5. Contact resistance

Center contact  $\leq 6m\Omega$   
Outer contact  $\leq 1m\Omega$

Material&Finish

Inner Contact: gold plated over Beryllium copper  
Outer Contact: gold plated over brass.  
Insulators: Teflon

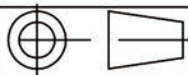

Scale

1:1

Name

Date

Designed

Tomson

19-Aug-11

Checked

Jason

19-Aug-11

Approved

Teresa

19-Aug-11

SMB-K3  
RF Coaxial Connector

UNLESS OTHERWISE SPECIFIED  
DIMENSIONS ARE mm, TOLERANCES ARE:  
FRACTIONS DECIMALS ANGLES  
.X $\pm$  .15  $\pm 1^\circ$   
.XX $\pm$  .05  
.XXX $\pm$



[www.rf-connector-china.com](http://www.rf-connector-china.com)