

This document contains proprietary information and such information may not be disclosed to others for any purposes, not used for sales/marketing/procurement purposes without written permission

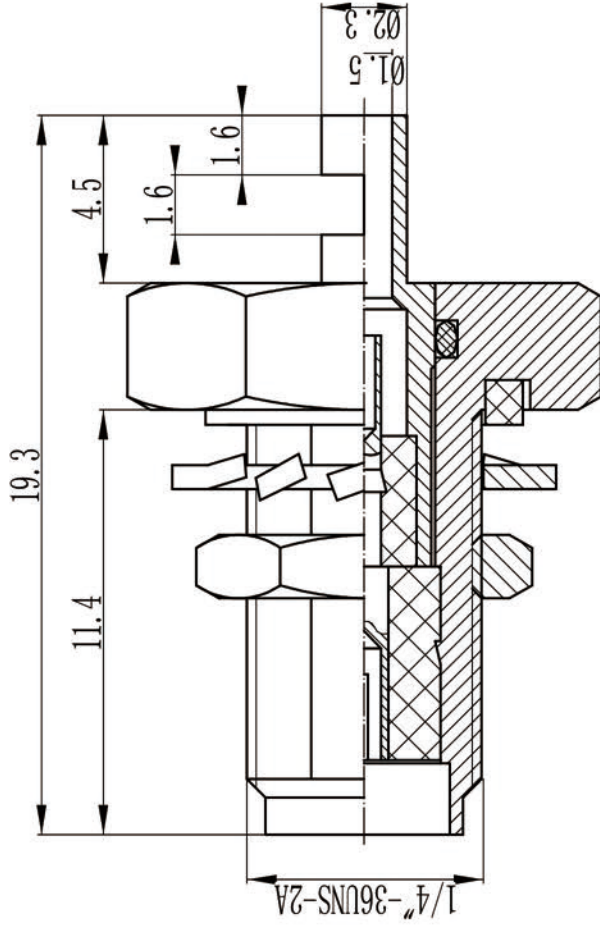

- 1 Electrical
 - 1.1 Impedance 50 Ω
 - 1.2 Dielectric withstanding voltage 1000V(volts RMS)
 - 1.3 Center contact resistance ≤ 3MΩ
 - 1.4 Outer contact resistance ≤ 2MΩ
 - 1.5 Insulation resistance: ≥5000MΩ
- 2 Environmental&Mechanical
 - 2.1 Temperature range -55℃~125℃
 - 2.2 RoHS Compliant
 - 2.3 Durability >500 cycles
- 3 Materials&Finish
 - 3.1 Body: Brass, Gold plated
 - 3.2 Insulator: Teflon
 - 3.3 Contact Pin: Beryllium Copper Gold plated

REV	DESCRIPTION OF REVISION	ECN NO.	BY	DATE	APPROVED
A	Initial Release		T. Shihua	03/07/18	03/07/18

DRAWN: T. Shihua 03/07/18		TITLE: RF Coaxial Connector	
ENGINEER: C. Tao 03/07/18		www.rf-connector-china.com	
APPROVED: W. Qiang 03/07/18		SMA Female B/H Conn. For 1.37 Cable	
TOLERANCES UNLESS OTHERWISE SPECIFIED		DIMENSION IN MILLIMETERS (mm)	
X	+0.05	SIZE: A4	SCALE: N/A
X	+0.20	SHEET: 1/1	REV: A
XX	+0.10		
ANGLES	±1°		
PART NO: SMA-KYL-37			

- Notes:
1. ALL SPECIFICATIONS ARE SUBJECT TO CHANGE NOTICE AT ANY TIME
 2. CUSTOMER OUTLINE DRAWING FOR REFERENCE ONLY