

This document contains proprietary information and such information may not be disclosed to others for any purposes, not used for sales/marketing/procurement purposes without written permission

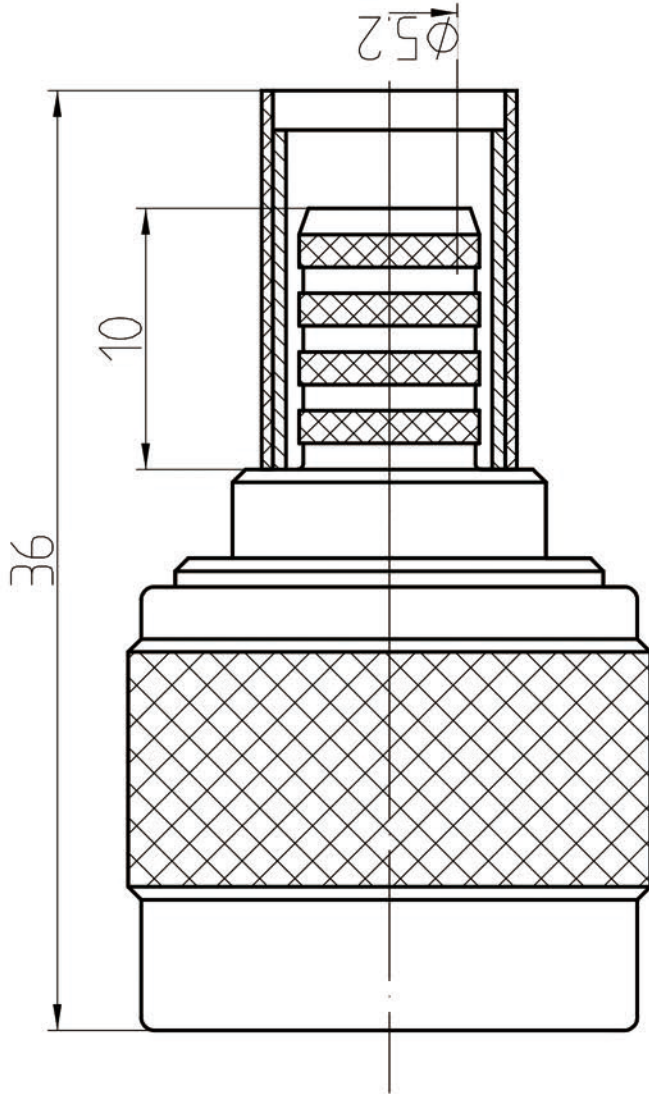

- 1 Electrical
 - 1.1 Impedance: 50 Ω
 - 1.2 Frequency: 0~6GHz
 - 1.2 Dielectric withstanding voltage: 1500V(volts RMS)
 - 1.3 Working Voltage: 1000V rms
 - 1.5 Insulation resistance: ≥5000MΩ
- 2 Environmental&Mechanical
 - 2.1 Temperature range: -40℃~125℃
 - 2.2 RoHs Compliant
 - 2.3 Durability: >500 cycles

- 3 Materials&plating
 - 3.1 Body: Brass, nickel plated
 - 3.2 Insulator: Teflon
 - 3.3 Contact Pin: Brass, Gold plated
 - 3.4 Housing: Brass, nickel plated
 - 3.5 Coupling nut: Brass, nickel plated

REV	DESCRIPTION OF REVISION	ECN NO.	BY	DATE	APPROVED
A	Initial Release		T. Shihua	15/02/08	15/02/08

Notes:

1. ALL SPECIFICATIONS ARE SUBJECT TO CHANGE NOTICE AT ANY TIME
2. CUSTOMER OUTLINE DRAWING FOR REFERENCE ONLY

DRAWN: T. Shihua 15/02/08
ENGINEER: C. Tao 15/02/08
APPROVED: W. Qiang 15/02/08
TOLERANCES UNLESS OTHERWISE SPECIFIED
X ±0.50
X ±0.20
XX ±0.10
ANGLES ±1°

TITLE:	
RF Coaxial Connector	www.rf-connector-china.com
N male Conn. For LMR300 (5D-FB) cable	
PART NO: N-JSD-PBY	SCALE: 1:1
	SHEET: 1/1
	REV: A

