

This document contains proprietary information and such information may not be disclosed to others for any purposes, not used for sales/marketing/procurement purposes without written permission

REV	DESCRIPTION OF REVISION	EON NO.	BY	DATE	APPROVED
A	Initial Release	---	T.Shihua	17/3/15	17/3/15
B	New Release	---	T.Shihua	18/3/15	18/3/15

1 Electrical

- 1.1 Impedance 50Ω
- 1.2 Frequency DC-300MHz
- 1.3 Dielectric withstanding voltage 5KV rms, 50Hz(Depending on cable)
- 1.4 Working voltage(at sea level) 1.6KV rms, 50Hz(Depending on cable)
- 1.5 Insulation resistance ≥5000·10³MΩ
- 1.3 Center contact resistance ≤ 2MΩ
- 1.4 Outer contact resistance ≤ 1MΩ
- 1.5 Corona extinction voltage ≥300V rms, 50Hz(Depending on cable)
(at 21000m)
- 1.9 Current rating continuous ≤ 10A

2 Environmental&Mechanical

- 2.1 Temperature range -55℃~155℃
- 2.2 RoHS Compliant
- 2.3 Durability >500 cycles

3 Materials&Finish

- 3.1 Body: Brass, Nickel plated
- 3.2 Insulator: Teflon
- 3.3 Contact Pin: Bronze, gold plated
- 3.4 Housing: Brass, nickel plated

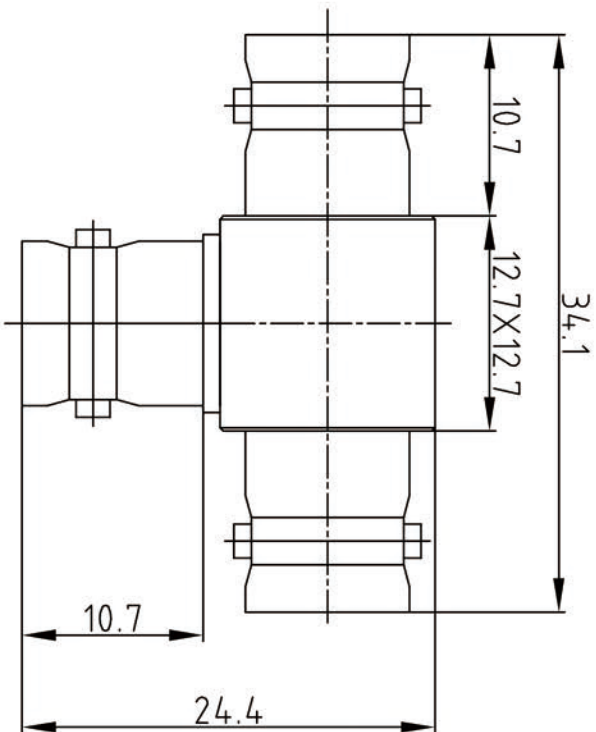

Notes:

- 1. ALL SPECIFICATIONS ARE SUBJECT TO CHANGE NOTICE AT ANY TIME
- 2. CUSTOMER OUTLINE DRAWING FOR REFERENCE ONLY

DRAWN: T.Shihua 17/3/15	TITLE: MHV-KKK	 www.t-relytech.com
ENGINEER: C.Too 17/3/15	MHV Female to Female to Female Adapter	
APPROVED: W.Qiang 17/3/15	PART NO: TRL-MHV-51291	SIZE: A4
TOLERANCES UNLESS OTHERWISE SPECIFIED		SCALE: N/A
X 0.50		SHEET: 1/1
X 0.20		REV: B
XX 0.10		
ANGLES 30°		