

1 Electrical

- 1.1 Impedance: 50Ω
- 1.2 Working voltage: ≤335V
- 1.3 Insulation resistance: ≥5000MΩ
- 1.4 Dielectric strength: 1000V
- 1.5 Center Contact resistance ≤ 3MΩ
- 1.6 Outer contact resistance ≤ 2.5MΩ

2 Material&Finish

- 2.1 Inner Contact: Beryllium-copper, gold plated
- 2.2 Outer Contact: Brass, gold plated
- 2.3 Insulators: Teflon

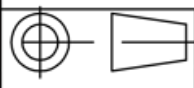

Scale

1:1

Name

Date

Designed

Tomson Tang

31-Mar-15

Checked

Jason Cai

31-Mar-15

Approved

Teresa

31-Mar-15

SMA-KWHD4  
RF Coaxial Connector

UNLESS OTHERWISE SPECIFIED  
DIMENSIONS ARE mm, TOLERANCES ARE:  
FRACTIONS DECIMALS ANGLES  
.X±.15 ±1°  
.XX±.05  
.XXX±



www.rf-connector-china.com