

A

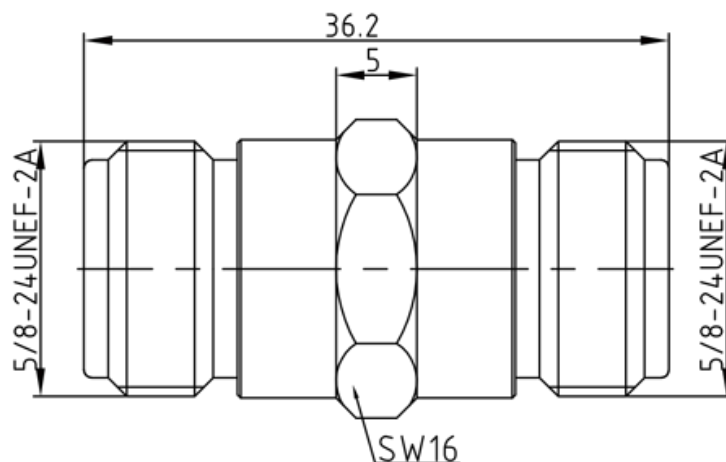

B

C

1 Electrical

- 1.1 Impedance: 50Ω
- 1.2 Frequency: 0-11GHz
- 1.3 Insulation resistance: $\geq 5000M\Omega$
- 1.4 Dielectric strength: 1500V
- 1.5 Contact resistance
 - Center contact $\leq 1M\Omega$
 - Outer contact $\leq 0.2M\Omega$

2 Material&Finish

- 2.1 Inner Contact: Phosphor bronze, gold plated
- 2. Outer Contact: Brass, Nickel plated
- 3. Insulators: PTFE

D

		Scale 1:1		N-KK N female to female adaptor	UNLESS OTHERWISE SPECIFIED DIMENSIONS ARE mm, TOLERANCES ARE: FRACTIONS DECIMALS ANGLES .X± .15 ±1° .XX± .05 .XXX±
No		Name	Date		
1	Designed	Tomson	14-Mar-09		
2	Checked	Jason	14-Mar-09		
3	Approved	Teresa	14-Mar-09		

