

This document contains proprietary information and such information may not be disclosed to others for any purposes, not used for sales/marketing/procurement purposes without written permission

- 1 Electrical
 - 1.1 Impedence 50 Ω
 - 1.2 Frequency DC ~18GHz
 - 1.3 Dielectric withstanding voltage 1500V(volts RMS)
 - 1.4 Working Voltage: 1000V rms
 - 1.5 Insulation resistance: ≥5000M Ω
 - 1.6 VSWR 1.3:1
- 2 Environmental&Mechanical
 - 2.1 Temperature range -40 °c ~85 °c
 - 2.2 RoHs Compliant
 - 2.3 Durability >500 cycles
- 3 Materials&plating
 - 3.1 Body: Stainless Steel, Passivated
 - 3.2 Insulator: Teflon
 - 3.3 Contact Pin: Beryllium-Copper, Gold plated
 - 3.4 Coupling nut: Stainless Steel, Passivated

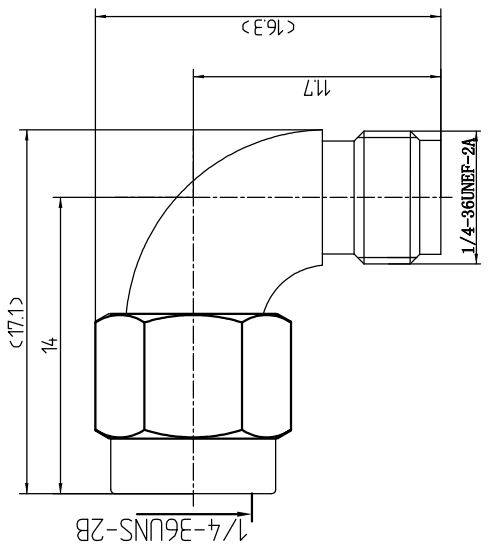

Notes:
 1. ALL SPECIFICATIONS ARE SUBJECT TO CHANGE NOTICE AT ANY TIME
 2. CUSTOMER OUTLINE DRAWING FOR REFERENCE ONLY

DRAWN: T. Shihua 08/06/16 ENGINEER: C. Tao 08/06/16 APPROVED: W. Qiang 08/06/16 TOLERANCES UNLESS OTHERWISE SPECIFIED X +0.50 XX +0.10 ANGLES ±1°	TITLE: Precision RF Adaptor SMA male to female R/A Adapter	www.teruli.com DIMENSION IN MILLIMETERS (mm)
PART NO: SMA-JWKG-T	SIZE: A4 SCALE: N/A SHEET: 1/1 REV: A	4